

系列间转接器

概述

各种规格的射频同轴转接器是实现不同系列和同系列内连接器正确转接的保证。我公司生产的系列间转接器品种齐全，能有效保证系统的转换与连接，符合 MIL-C-39012 和 IEC 的相关技术规定，具有尺寸小、电气性能俱佳的特点。

执行标准

质量等级	规范代号	适用产品类型
企军标	Q/Jc20608-2018	转接器
七专	Q/Jc20456-2014	转接器
可靠性	LMS070400019-2013	转接器
宇标	Q/QJA 20116/18-2018	转接器

L29/N 型

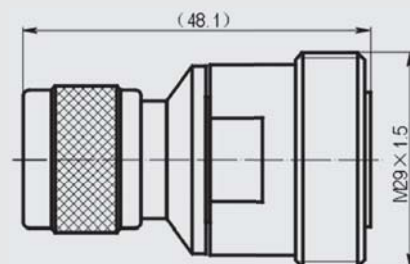
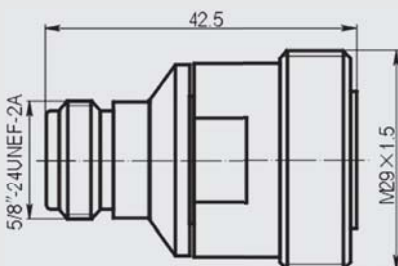
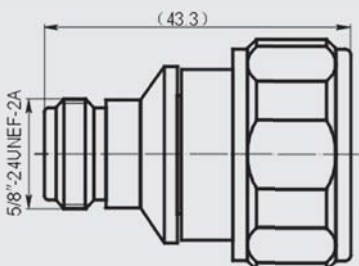
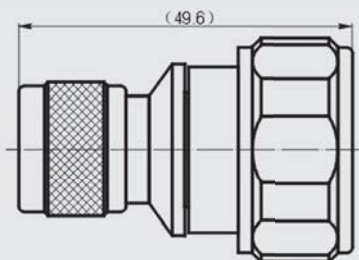

N/TNC 型



N/TNC-JJ

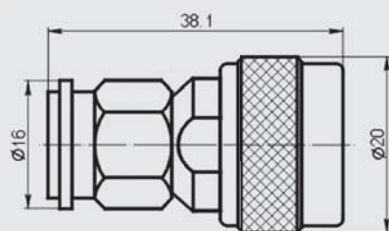

N/TNC-JK

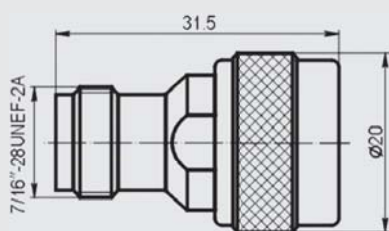

N/TNC-KK

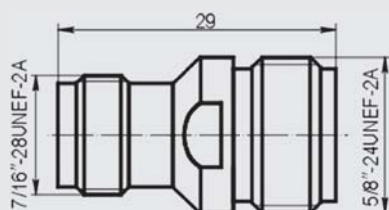

N/TNC-KJ

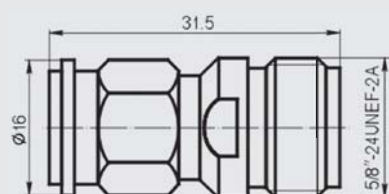

N/BNC 型



N/BNC-JJ

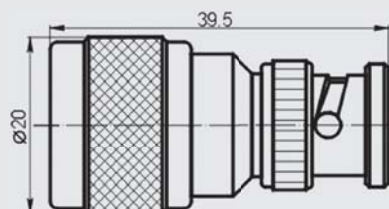

N/BNC-JK

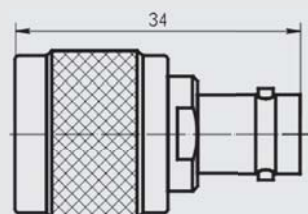



N/BNC-KK

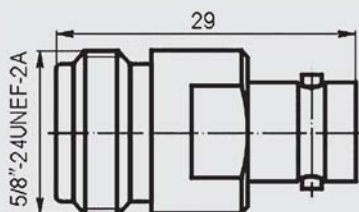

N/BNC-KJ
N/BNC-75KJ

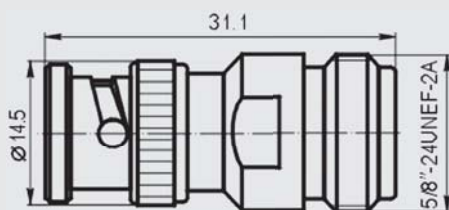

N/BNC-KFK

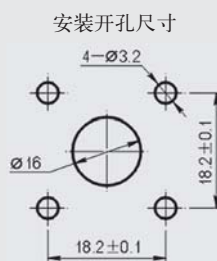
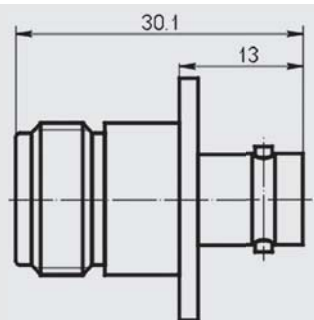

N/SMA 型



N/SMA-JJ

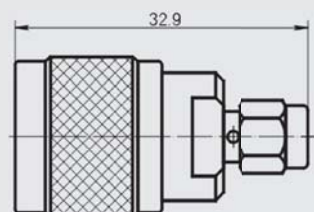

N/SMA-JK

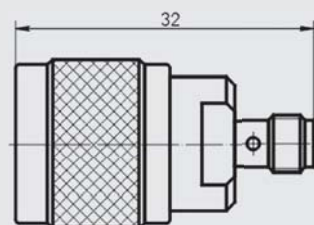

N/SMA-KK

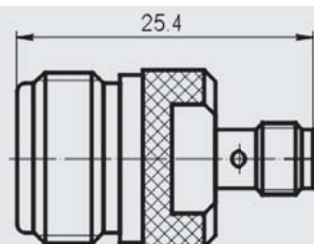



N/SMA-KJ

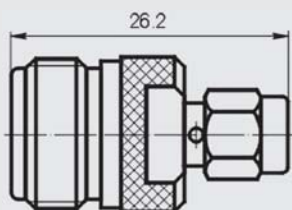

N/SMA-KFJ

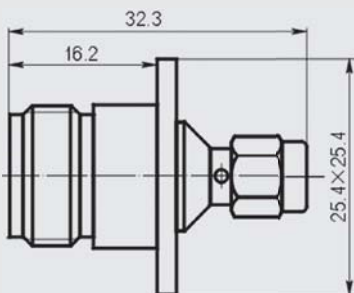

安装开孔尺寸

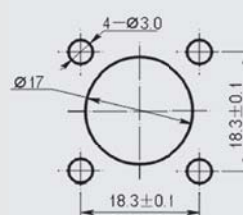

N/SMA-KFK

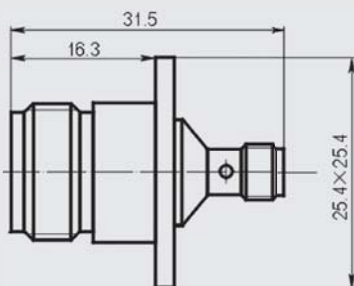

安装开孔尺寸

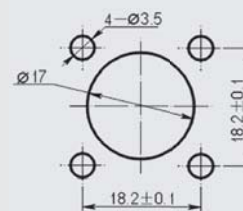

N/SMA-KYK

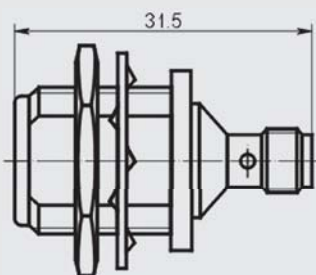

安装开孔尺寸

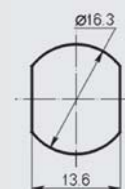

N/SMA-KYK2

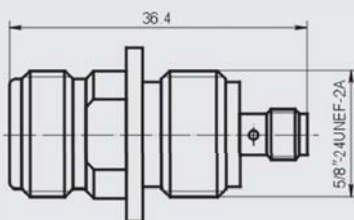

N(M)/SMA-KYK

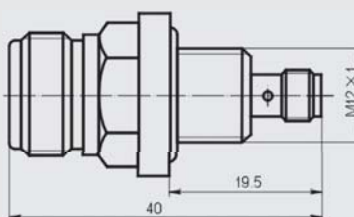



N(M)/SMA-KYK1

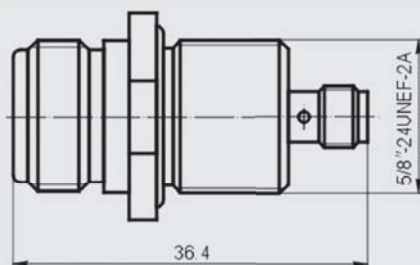

N(M)/SMA-KYKT

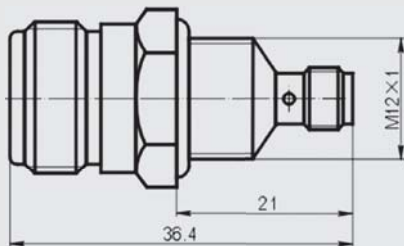

TNC/SMA 型



TNC/SMA-JJ

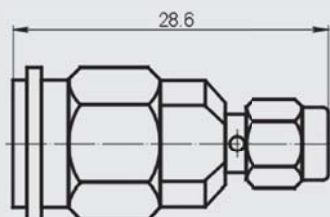

TNC/SMA-JK

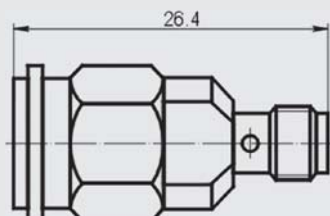

TNC/SMA-KK

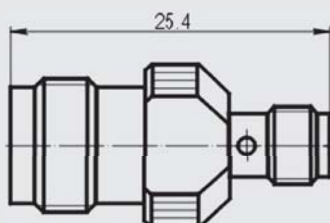

TNC/SMA-KJ

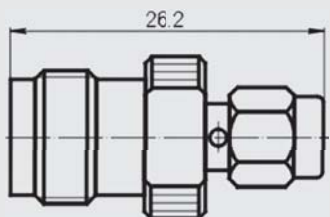



TNC/SMA-KFK

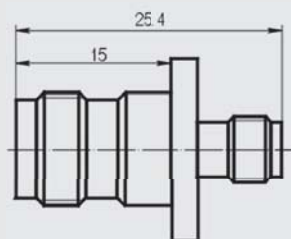

安装开孔尺寸

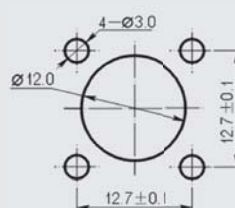

TNC/SMA-KYK

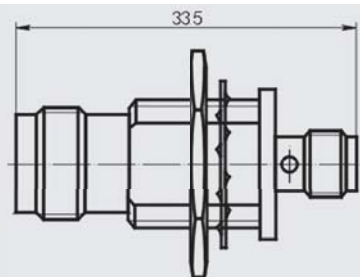

安装开孔尺寸

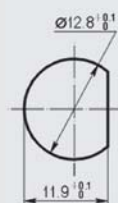

N/BMA 型



N/BMA-JJ

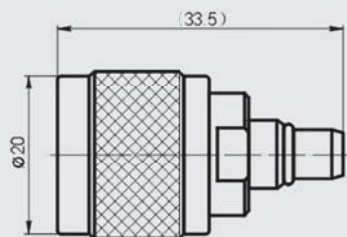

N/BMA-JK

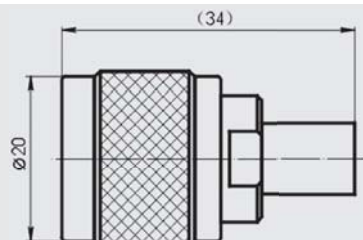

N/BMA-KK

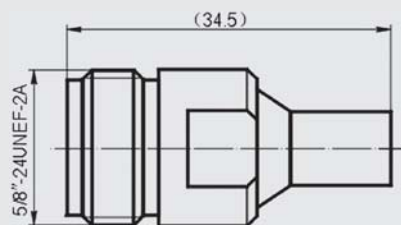

N/BMA-KJ

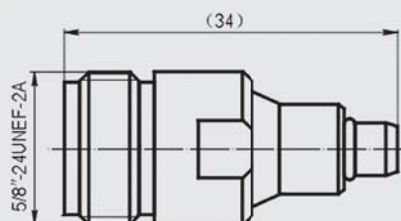

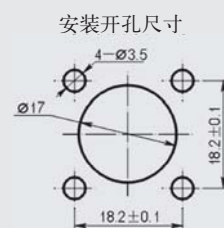
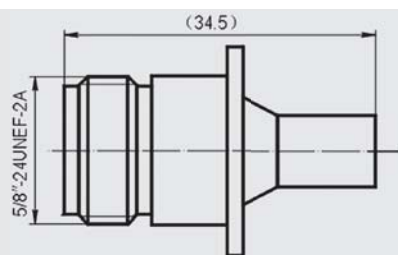

N/SMB 型

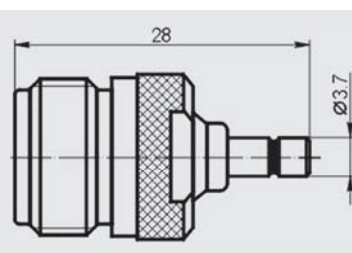
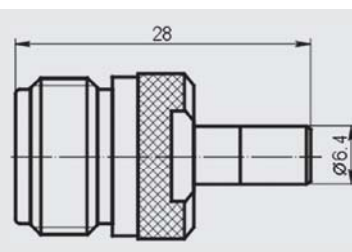
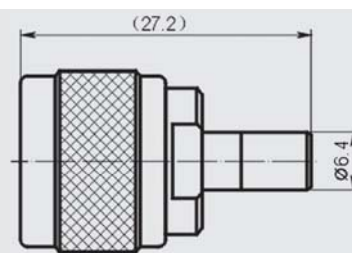
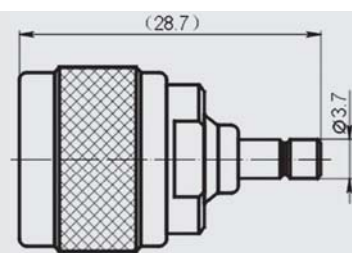

BNC/SMA 型

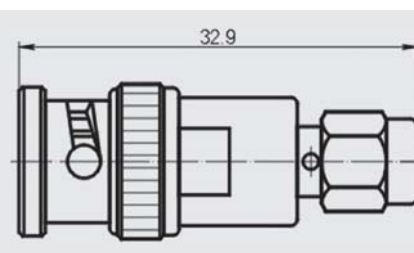
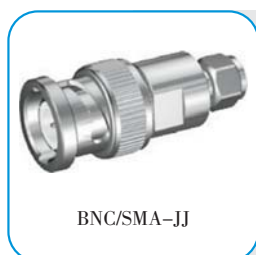



BNC/SMA-JK

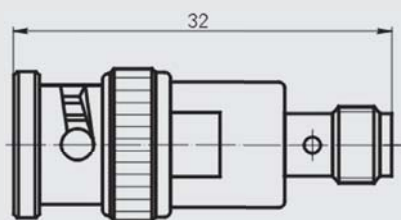

BNC/SMA-KK

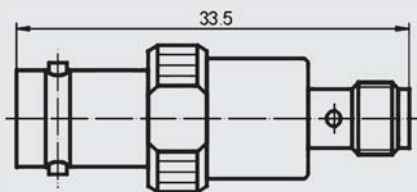

BNC/SMA-KJ

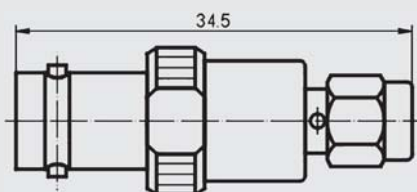

BNC/SMA-KFK

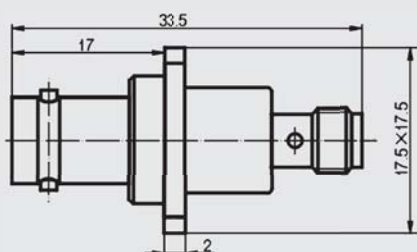

BNC/SMB 型



BNC/SMB-JJ

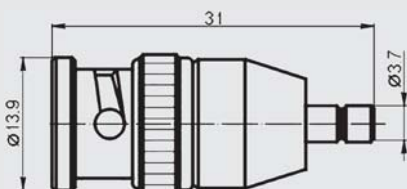

BNC/SMB-JK

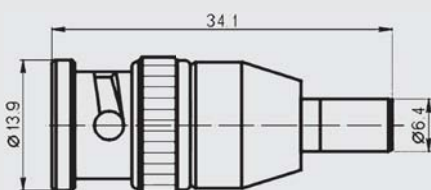



BNC/SMB-KK

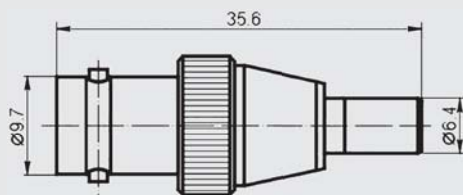

BNC/SMB-KJ

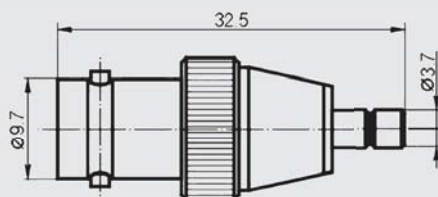

SMA/BMA 型



SMA/BMA-JJ

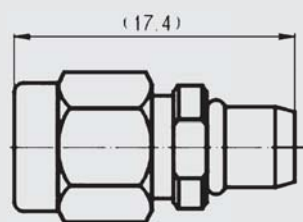

SMA/BMA-JK

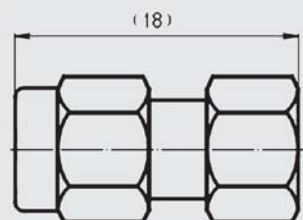

SMA/BMA-KK

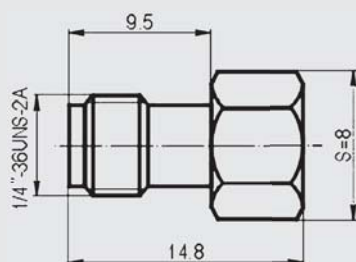

SMA/BMA-KJ

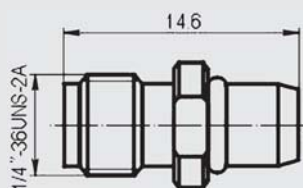



SMA/BMA-KFKA(G)

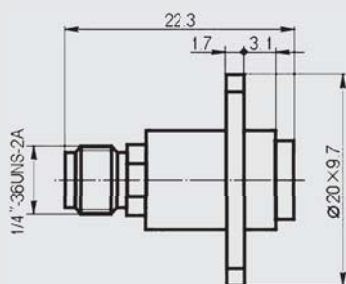

安装开孔尺寸

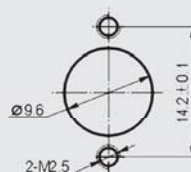

SMA/BMA-KFJ

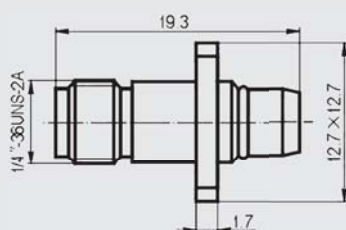

安装开孔尺寸

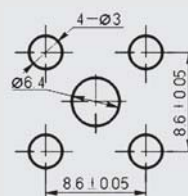

SMA/BMA-KYJ

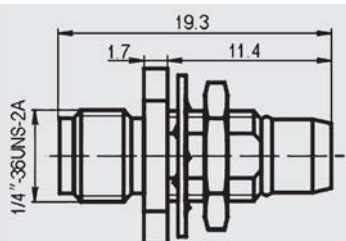

安装开孔尺寸



SMA/SMB 型



SMA/SMB-JJ

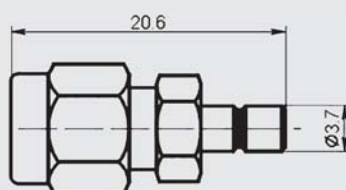

SMA/SMB-JK

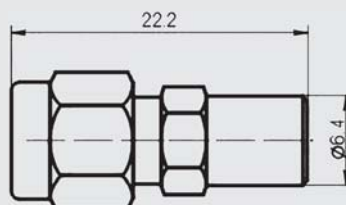

SMA/SMB-KK

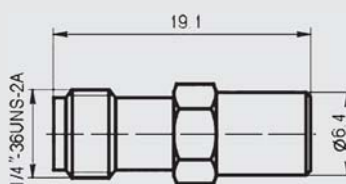



SMA/SMB-KJ

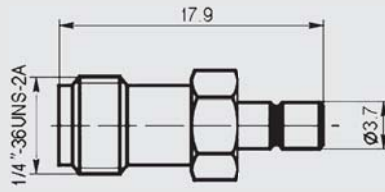

SMA/MCX 型



SMA/MCX-JJ

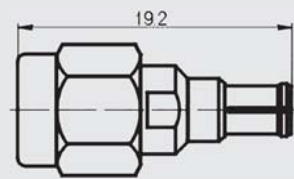

SMA/MCX-KK

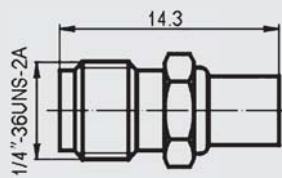

SMA/MCX-KJ

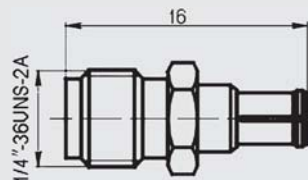

N/SSMA 型



N/SSMA-JK

